

Universal Locking Wheel Nut Remover



Information

- Ideal for the removal of rounded wheel nuts & most types of locking wheel nuts in an emergency.
- Made using S1 steel for the A and B blades.

Precautions

Always wear safety gear.
Working in a clean and safe environment.
This task should be carried out by trained personnel.
Make sure to consult manufacturers manual.
Do NOT use with air tools.

Specifications

- Contains two sizes of impact cutting blades to fit most common locking wheel nuts by cutting into the outer rim, as well as a set of double-sided blades for moulding in to the socket key shape directly.
- This set provides a removal solution to a wide range of socket sizes, types, profiles and materials including those with spinning collars.
- Additional blade packs available.
- Universally compatible tool.
- Compatible with air tools.

Contents

1. Outer Shroud.
2. Inner Shroud.
3. Two Blade and Mandrel.
4. Three Double Sided Moulding Blades.
5. Main Unit.
6. Centre Punch.
7. Hand Protection Guard.
8. 1/2" Impact Socket (24mm Hex).
9. Impact Driver.

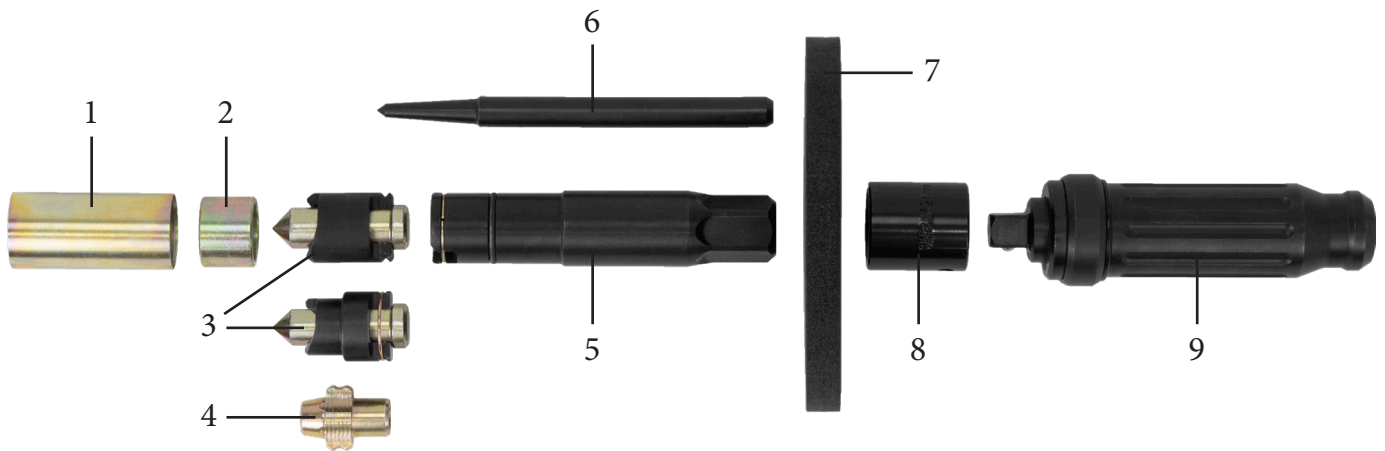

Instructions

Step 1

- Use the centre punch to place a guide marker in the middle of the locking wheel nut.
- If the punch successfully indents the locking wheel nut go ahead with the blade & mandrel instructions.
- If the punch fails to make an indent on hardened nuts, proceed with moulding blade instructions.

Blade & Mandrel Assembly

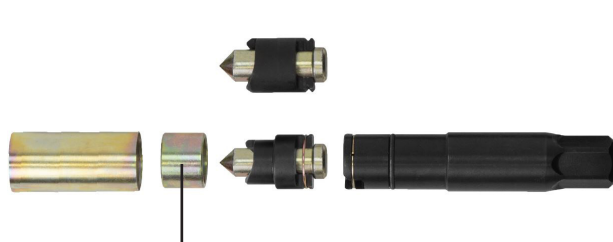

Use Inner shroud with smaller blade

Moulding Blade Assembly

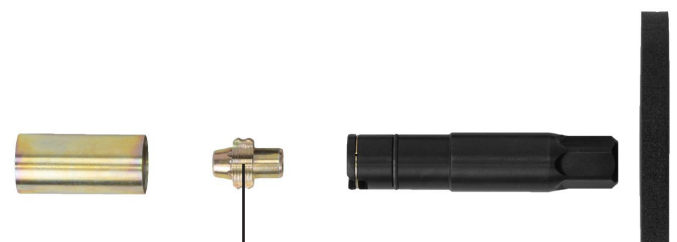

Fit moulding blades directly

Instructions

Step 2

- Align the assembled unit with the wheel nut using the punch marker made earlier and hammer the back of the main unit.
- Continue to hammer until the impact blades cut into the sides of the socket enough to gain grip.
- Or until the moulding blades have pressed in to the key profile enough to gain grip.



Step 3

- Remove the hand guard and fit the supplied socket to allow for removal with an air tool.
- Ensure the blades are making firm contact with the indents made in step 2.
- Slowly increase torque from a lower setting until the wheel nut begins to loosen.
- Ensure a firm connection, slipping may cause damage.



Step 4

- If an air tool is not available you can use the impact driver attachment and a hammer. (Can use any 1/2" drive tool)
- Fit the impact driver to the socket, the hand guard to the driver, and position the blades over the wheel nut.
- Apply pressure to the nut to create a firm connection and twist the handle.
- Repeatedly impact the driver until nut is loosened.



Warranty

If you are unsure on how to use the item please contact us. If it were to fail due to a manufacturing fault or poor workmanship we will repair or replace it. Please contact your local dealer in the event you need to send the item back. You can also make a repair/replacement request on our website and download & complete the form online. Normal wear and tear along with misuse will void any warranty. Consumables are not covered under warranty.

www.welzh.com

Limited **12 month** warranty



Welzh Werkzeug Ltd
Loanwath Road
Gretna, Scotland
DG16 5HD
+44 (0)1461 700120